



LINEAR ACTUATOR

VMD3 series

12/24V DC Motor
 Max. Load: 1000N
 Max. Speed: 45mm/sec
 Compact and Powerful

Feature :

Aluminum Extension & Outer Tubes
 Clevis to Clevis Mounting
 Stroke: 50, 100, 150, 200, 250, 300mm
 Duty Cycle: 25%
 Environment: -26°C ~65°C
 Preset Limit Switches
 Gear Ratio: 5:1, 10:1, 20:1, 30:1, 40:1

Option :

Hall Effect Sensor
 Potentiometer
 IP54 / IP65

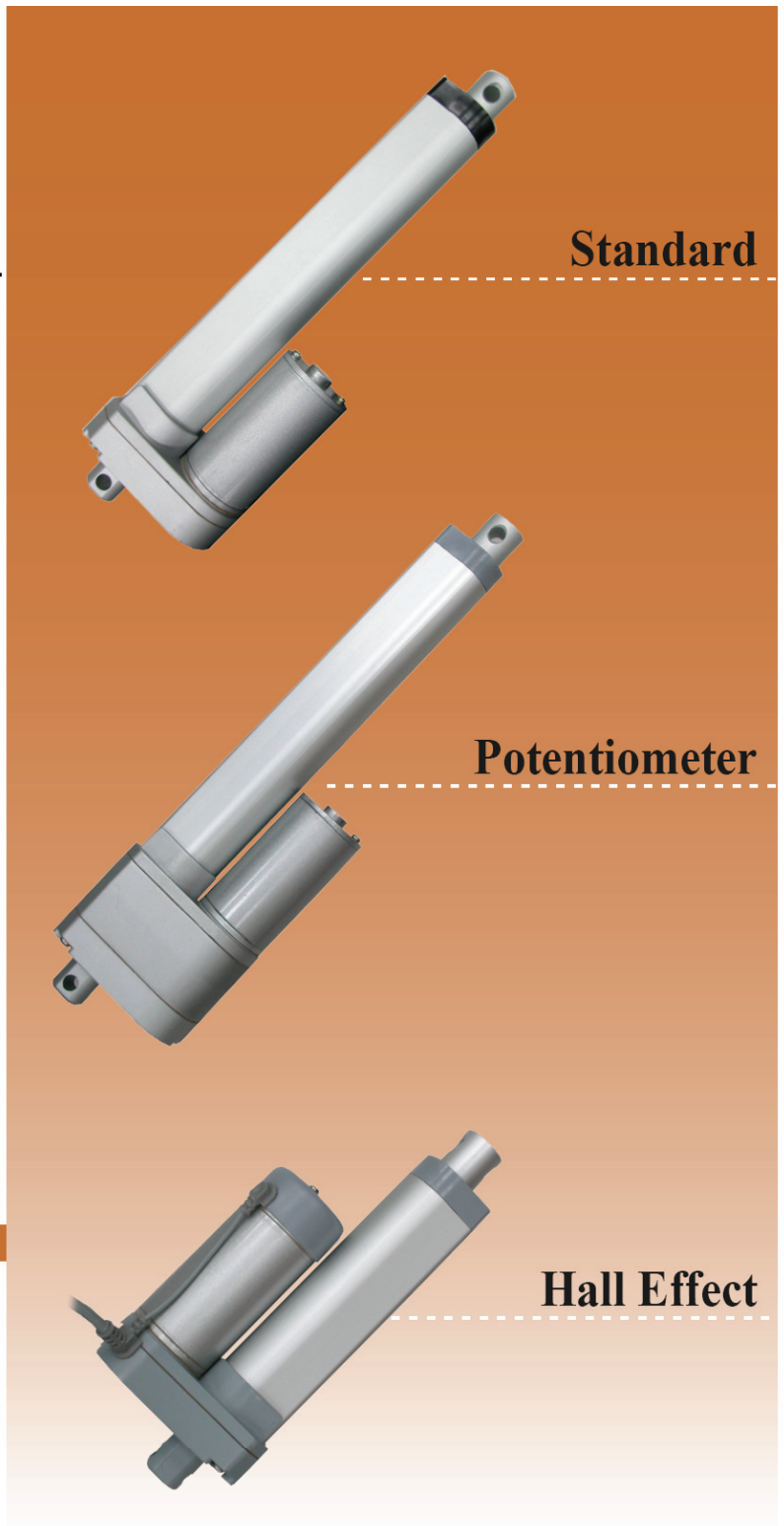

Standard

Potentiometer

Hall Effect

Model No. Designations:

VMD3	· 12	· 20	· 200	· HS	· 54.65
	Voltage	gear ratio	stroke	option	IP
	12-12V DC	5-5:1	50mm(2")	HS: Hall Effect Sensor	IP54
	24-24V DC	10-10:1	100mm(4")	HS2: Dual Hall Effect Sensors	IP65
		20-20:1	150mm(6")	POT: Potentiometer Sensor	
		30-30:1	200mm(8")		
		40-40:1	250mm(10")		
			300mm(12")		

Speed vs Load

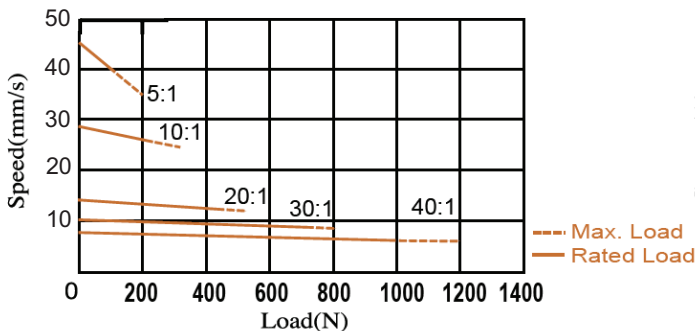

Current vs Load

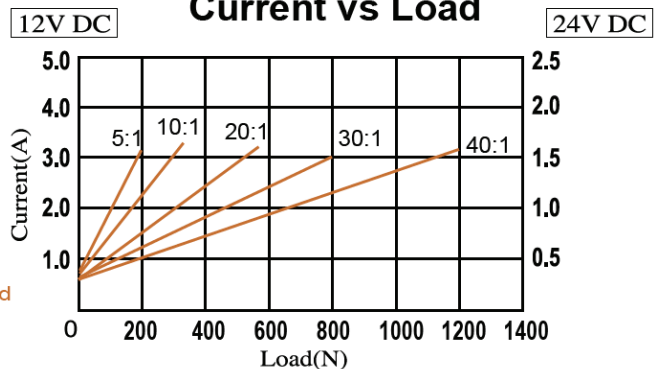

Venture VMD3 Series Linear Actuator

	Stroke	50	100	150	200	250	300
	A	158	209	260	311	362	413
Standard	B	208	309	410	511	612	713

A: Retracted Length
B: Extended Length
Stroke = B - A

(mm)

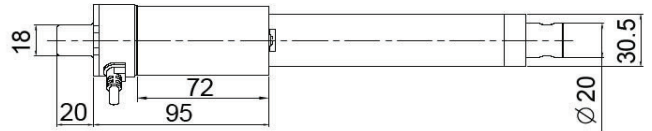
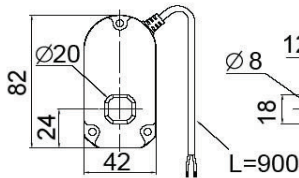

B

	Stroke	50	100	150	200	250	300
	A	195	246	297	348	399	450
Potentiometer	B	245	346	447	548	649	750

(mm)

Value of POT	
Stroke(mm)	Resistance(Ω)
50	0.3-9.3K
100	0.3-9.7K
150	0.3-8.6K
200	0.3-9.6K
250	0.3-9.3K
300	0.3-9.3K

Remark: tolerance: ±0.3K

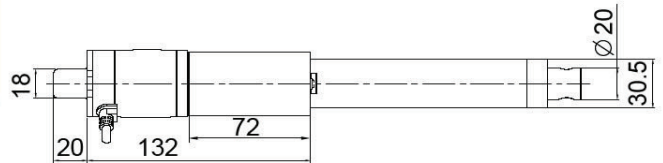
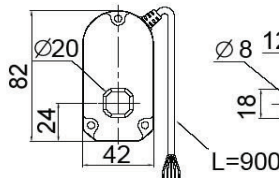

B

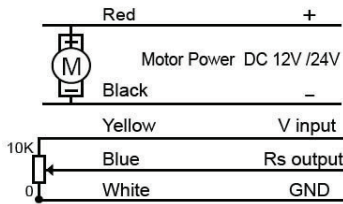

	Stroke	50	100	150	200	250	300
	A	158	209	260	311	362	413
Hall Effect	B	208	309	410	511	612	713

(mm)

Hall Sensor	
Gear Ratio	Resolution(Pulses/mm)
5:1	2.3
10:1	3.6
20:1	6.9
30:1	10.6
40:1	14.3

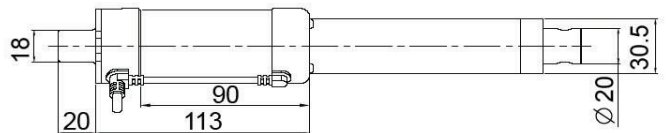
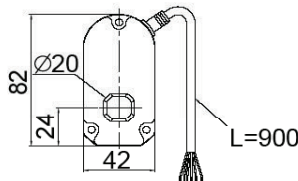

B

Standard Plug for Hall Sensor Version

*Pin Data2 for 2 Hall Sensor Only

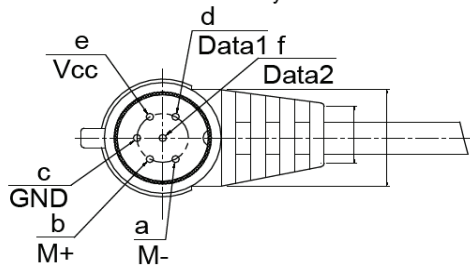

Wire Connection

